

# SF16 Multi Color RGBW Silicone LED Linear "GLOW" Flex

## NPA-SF167 -24V-5050-72-RGBW

### Specification

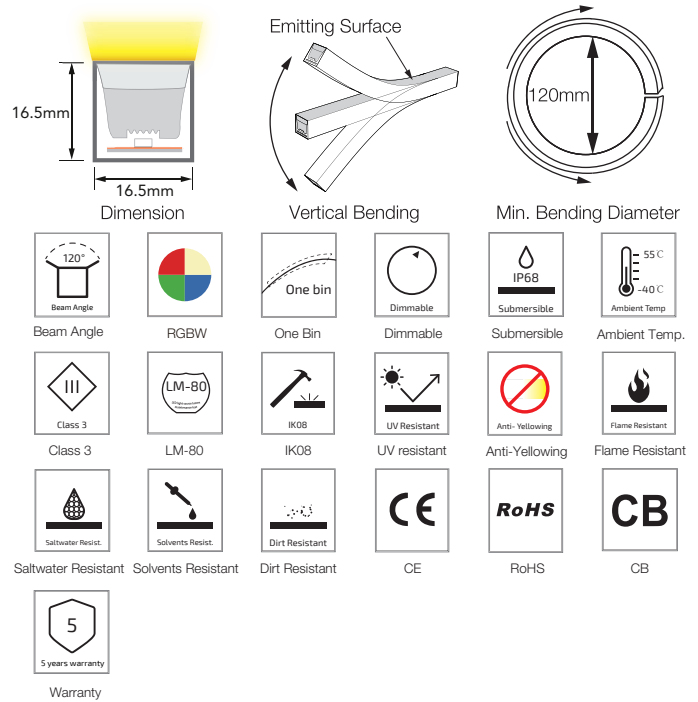
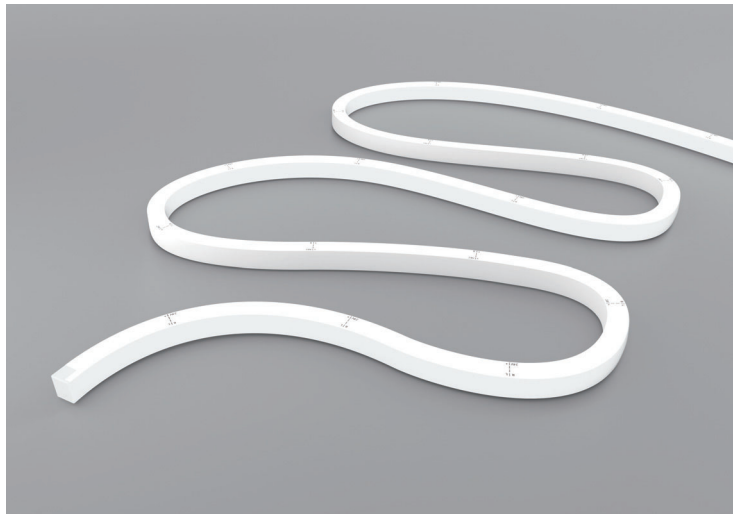

### Technical Parameters

Electrical	
Input Voltage	24V DC
Power Consumption	17W/m
Physical	
LED Count	72 LEDs/m
Cutting Unit	6 LEDs
Cutting Unit Length	83.3mm
Minimum Bend Diameter	120mm
Output	
LED Light	Epistar SMD LED 5050
Color	RGBW(2700/3000/4000K/5000K)
Max Run Length*	
Single Feed	8M
Double Feed	16M
Beam Angle	120°
Lumen Maintenance	70,000 Hours L70 @ 25°C 50,000 Hours L70 @ 50°C
Temperature Ranges	
Installation	0°C to 50°C
Operating	-40°C to 55°C
Dependability	
Warranty	5 Years Warranty
IP Rating	IP68 Wet location submersible <2m

Emitting Color		Lumen Output
	Red	13lm/m
	Green	150lm/m
	Blue	34lm/m
	RGB(White)	480lm/m
	3000K	250lm/m

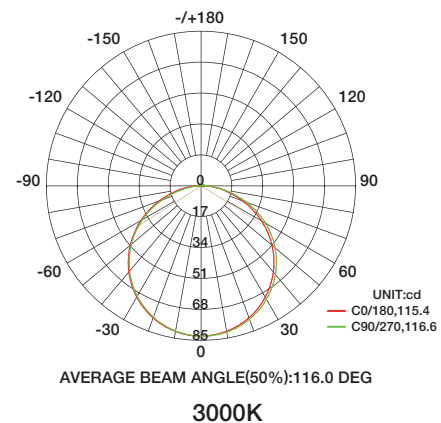

### Illuminance Distribution

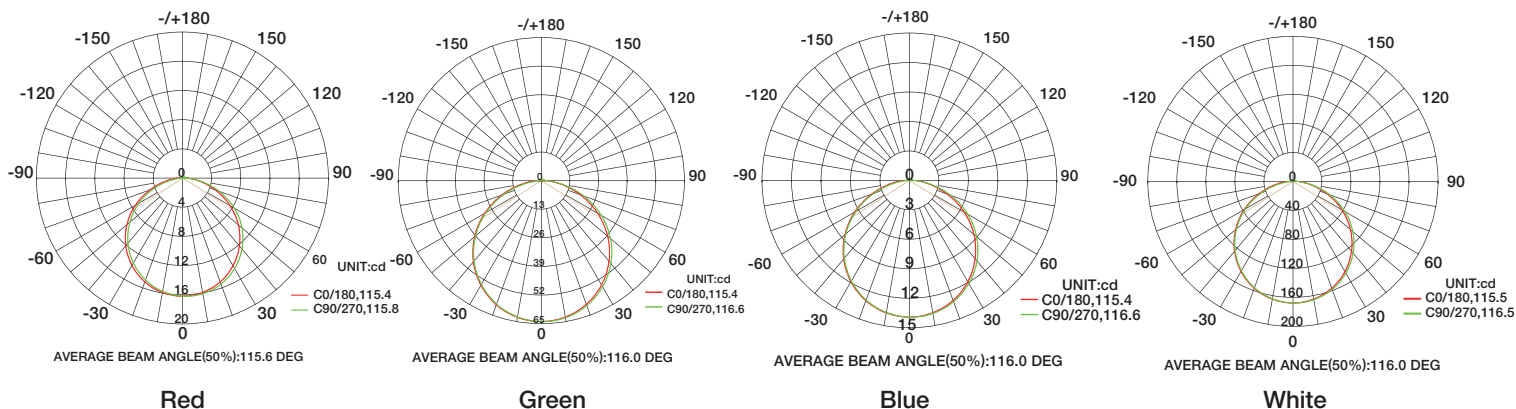

# SF16 Multi Color RGBW Silicone LED Linear "GLOW" Flex

## Connection

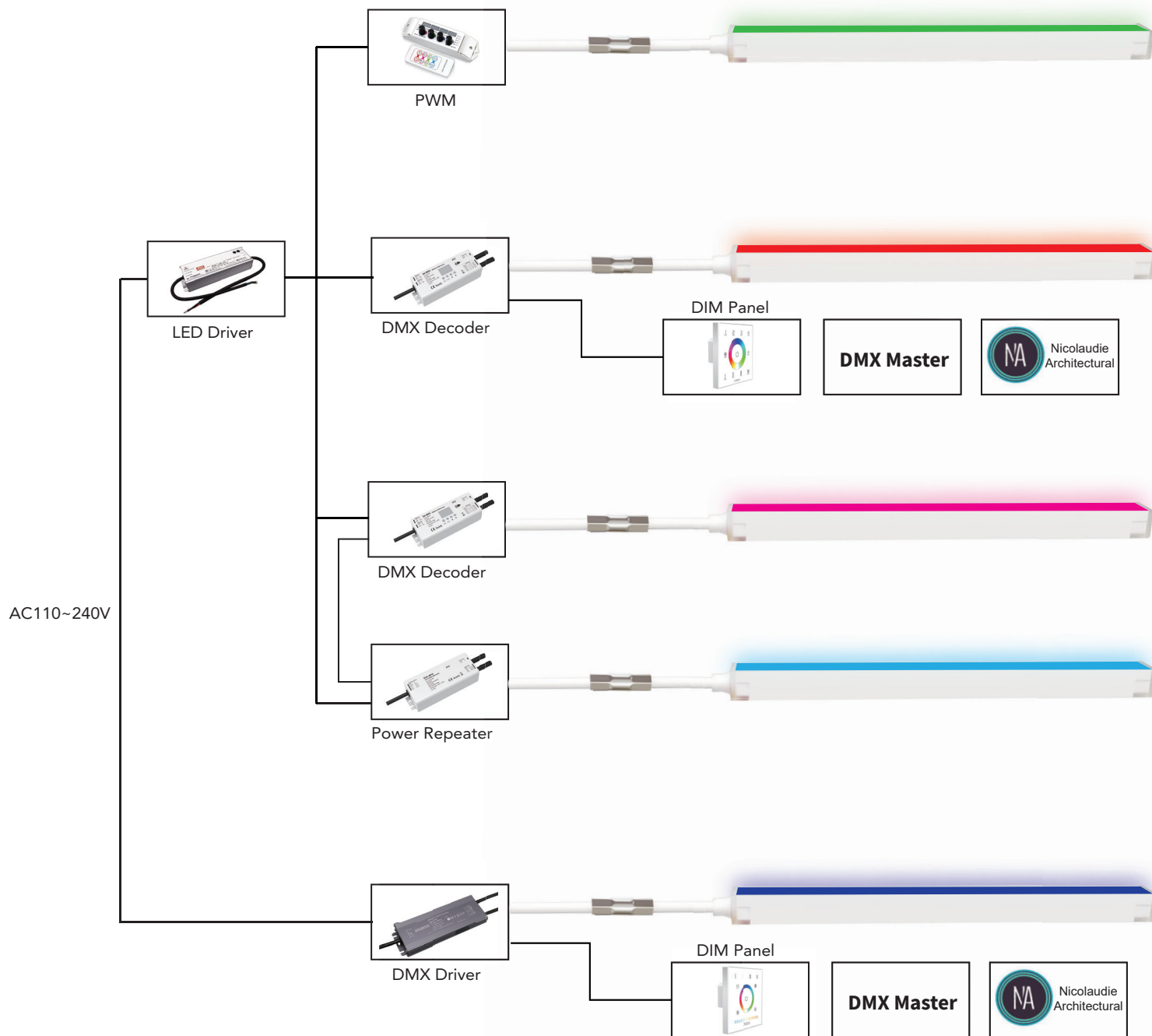

# SF16 Configuration and Accessories

## Mold injection Connector

(IP68 Factory Assembly Only)

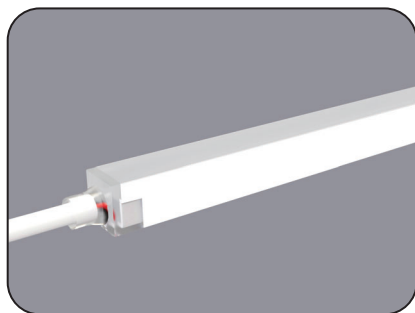

Direct Entry Connector  
MJ-SF16-RGBW-D01/02/03  
MJ-SF16-RGBW-D01SM  
MJ-SF16-RGBW-D02SF  
MJ-SF16-RGBW-D03SFM

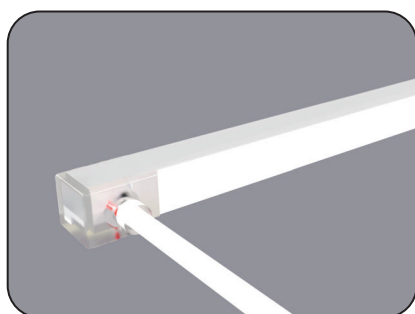
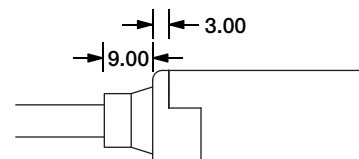
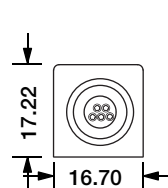

Side Entry Connector  
MJ-SF16-RGBW-S01/02/03  
MJ-SF16-RGBW-S01SM  
MJ-SF16-RGBW-S02SF  
MJ-SF16-RGBW-S03SFM

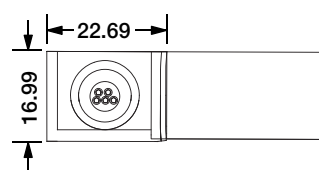
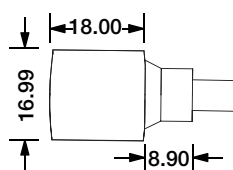

Bottom Entry Connector  
MJ-SF16-RGBW-B01/02/03  
MJ-SF16-RGBW-B01SM  
MJ-SF16-RGBW-B02SF  
MJ-SF16-RGBW-B03SFM

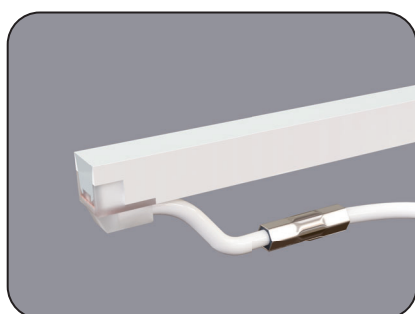
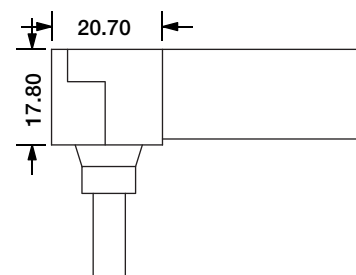
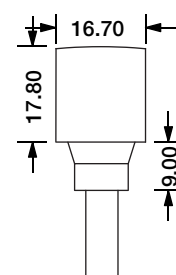

L Shape Entry Connector  
MJ-SF16-RGBW-L01/02/03  
MJ-SF16-RGBW-L01SM  
MJ-SF16-RGBW-L02SF  
MJ-SF16-RGBW-L03SFM

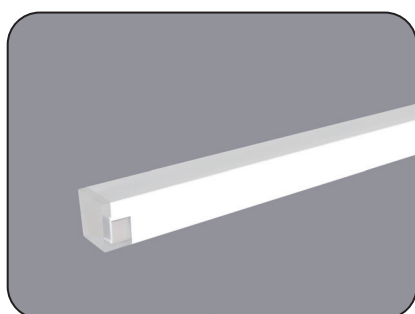
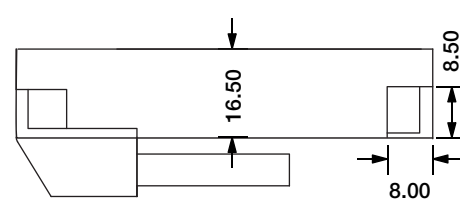
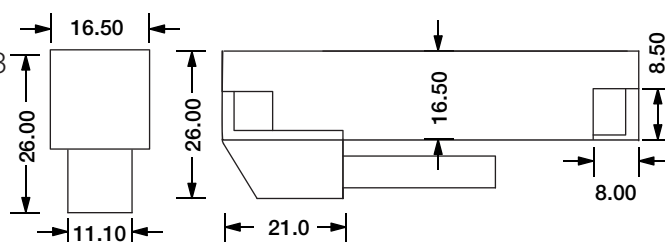

End Cap

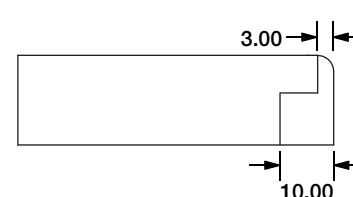
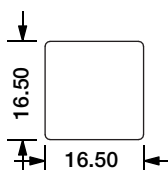

# SF16 Configuration and Accessories

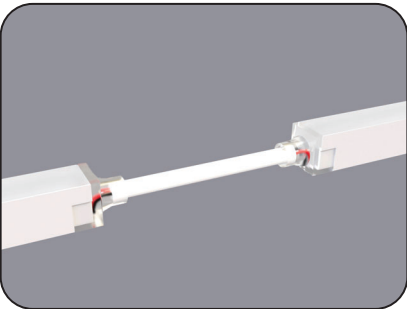

Jumper  
MJ-SF16-RGBW-D-JC

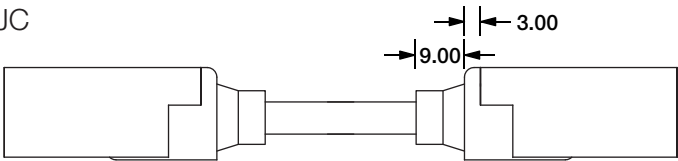

DIY Snap End Cap

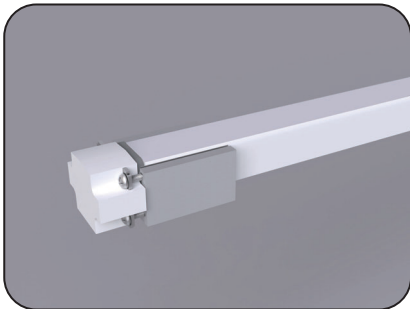
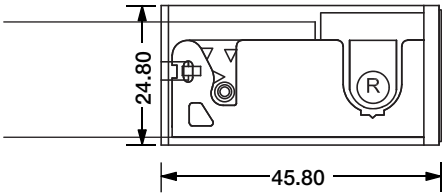
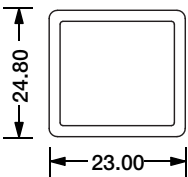

DIY Screw End Cap  
DIY-SC-END-16

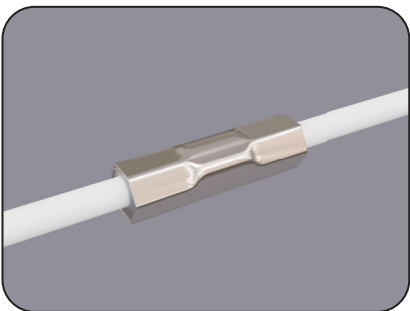
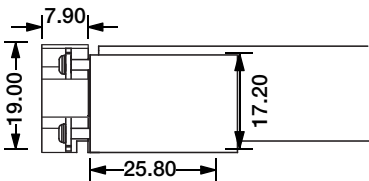
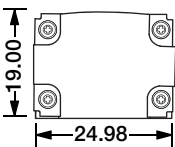

Waterproof Interrupter

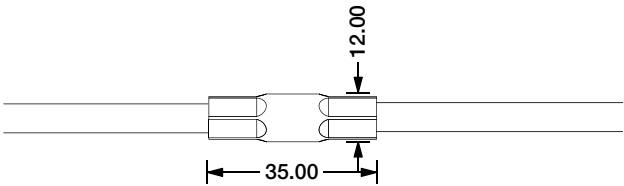

Male Connector  
M12-M-5C-20AWG-D6-W-0327-S

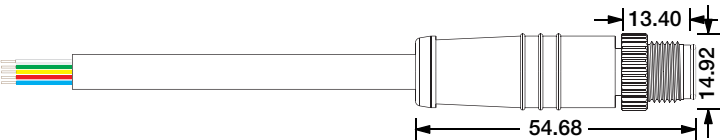

# SF16 Configuration and Accessories



Female Connector  
M12-F-5C-20AWG-D6-W-0327-S

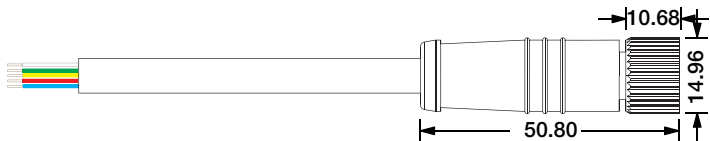

Male Connector End Cap  
SYZ-EC-M12-M

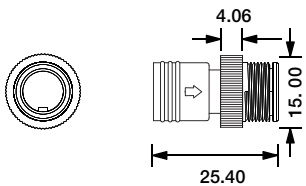

Female Connector End Cap  
SYZ-EC-M12-F-5C

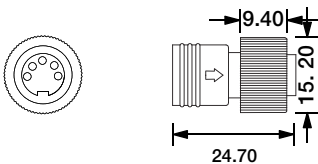

# LED Linear Flex Mounting Channel

## 1. Aluminum Channel

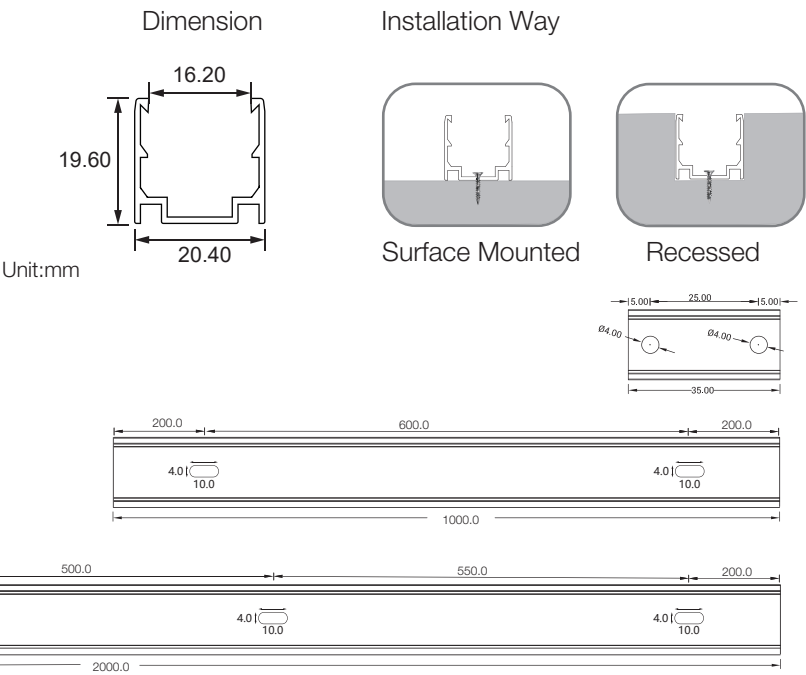
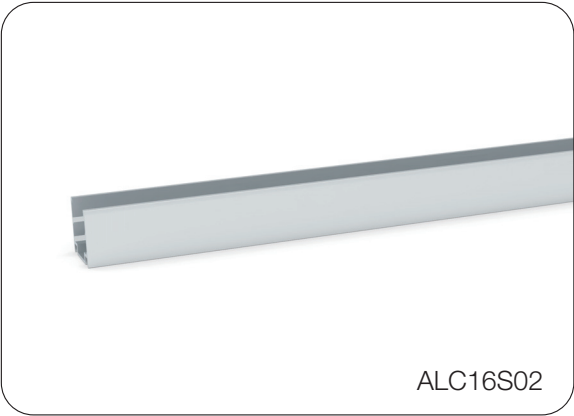

Model	W x H(mm)	Standard Length	Screw Holes	Holes Numbers	Suitable Product
ALC16S02-035	20.40*19.60	35mm	Φ4.0mm	2	F16, SF16
ALC16S02-100		1000mm	○4.0mm	2	F16, SF16
ALC16S02-200		2000mm	○4.0mm	4	F16, SF16

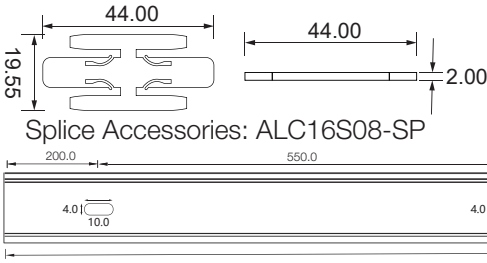
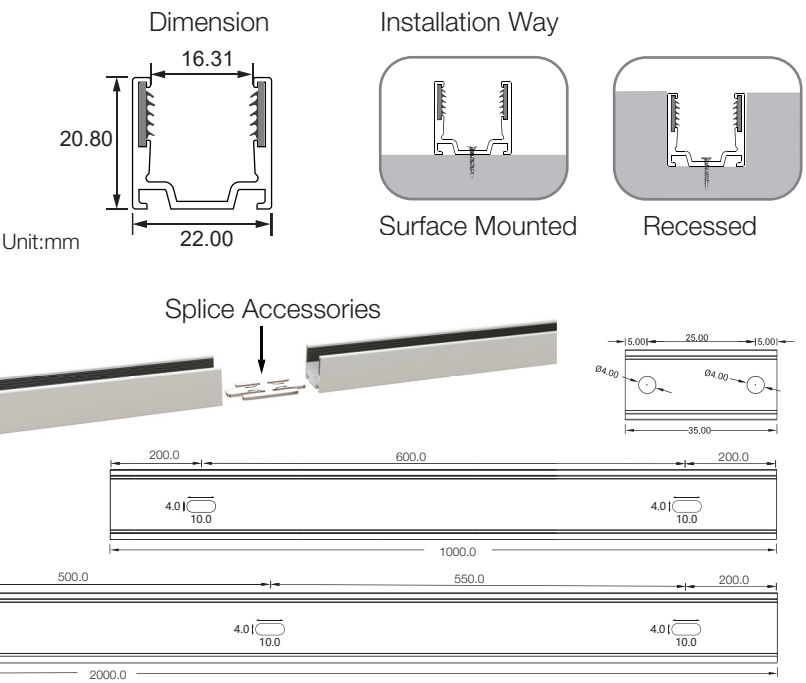

Model	W x H(mm)	Standard Length	Screw Holes	Holes Numbers	Suitable Product
ALC16S08-035	22.00*20.80	35mm	Φ4.0mm	2	F16, SF16
ALC16S08-100		1000mm	○4.0mm	2	F16, SF16
ALC16S08-200		2000mm	○4.0mm	4	F16, SF16

# LED Linear Flex Mounting Channel

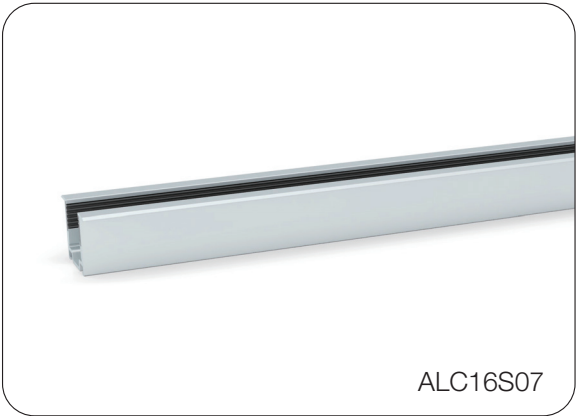

ALC16S07

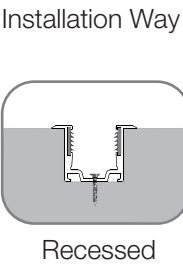
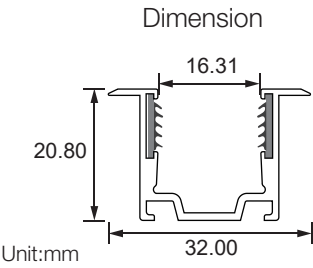

Recessed

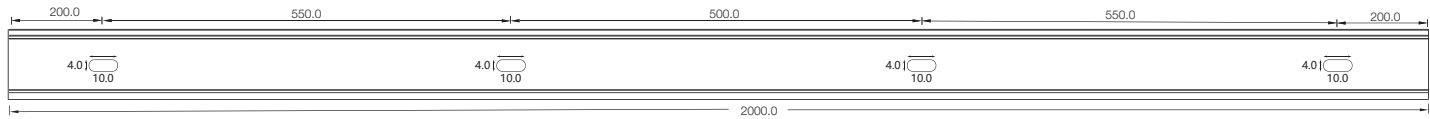
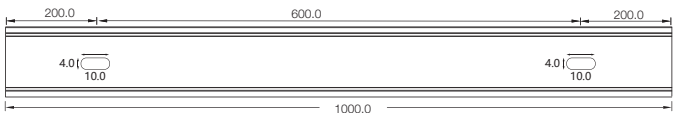
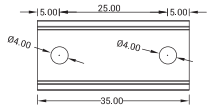

Model	W x H(mm)	Standard Length	Screw Holes	Holes Numbers	Suitable Product
ALC16S07-035	22.0*22.8	35mm	Φ4.0mm	2	F16, SF16
ALC16S07-100		1000mm	○4.0mm	2	F16, SF16
ALC16S07-200		2000mm	○4.0mm	4	F16, SF16



ALC16H02

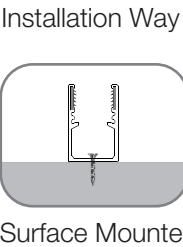
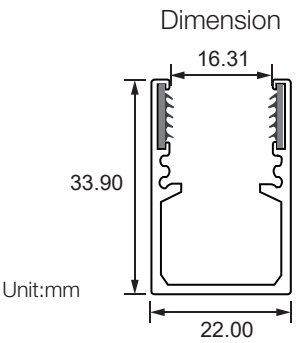

Surface Mounted

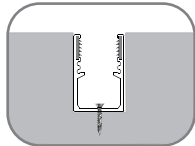

Recessed

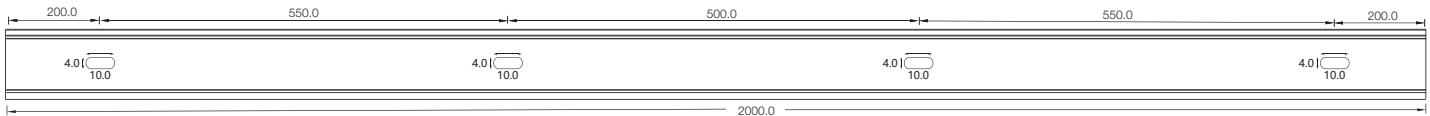
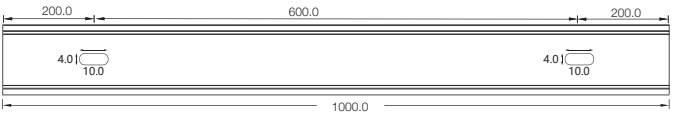
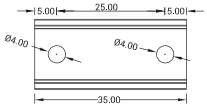

Model	W x H(mm)	Standard Length	Screw Holes	Holes Numbers	Suitable Product
ALC16H02-035	22.00*33.90	35mm	Φ4.0mm	2	F16, SF16
ALC16H02-100		1000mm	○4.0mm	2	F16, SF16
ALC16H02-200		2000mm	○4.0mm	4	F16, SF16

# LED Linear Flex Mounting Channel

## 2. Flexible Aluminum Channel

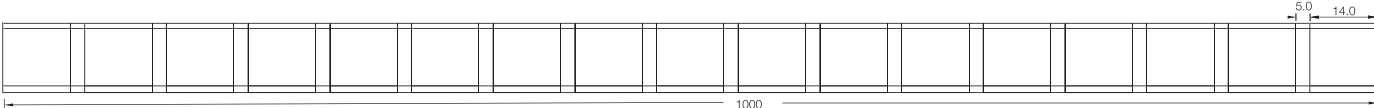
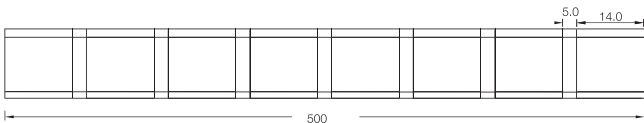
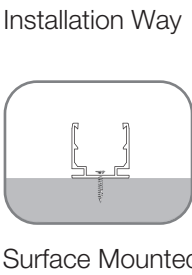
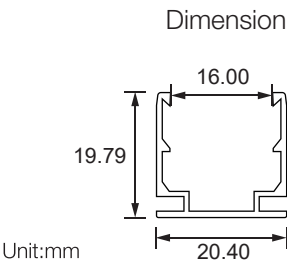
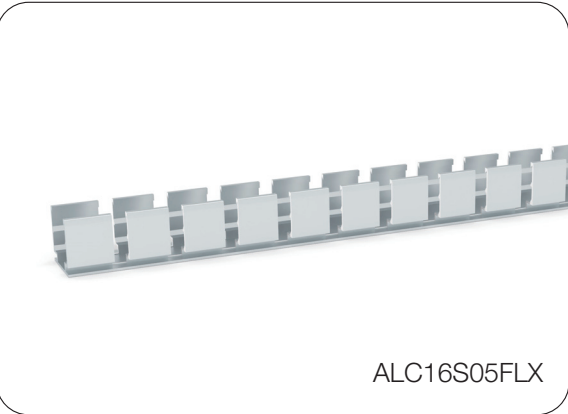

Model	W x H(mm)	Standard Length	Suitable Product
ALC16S05FLX-05	20.4*19.79	500mm	F16, SF16
ALC16S05FLX-10		1000mm	F16, SF16

## 3. Plastic Channel

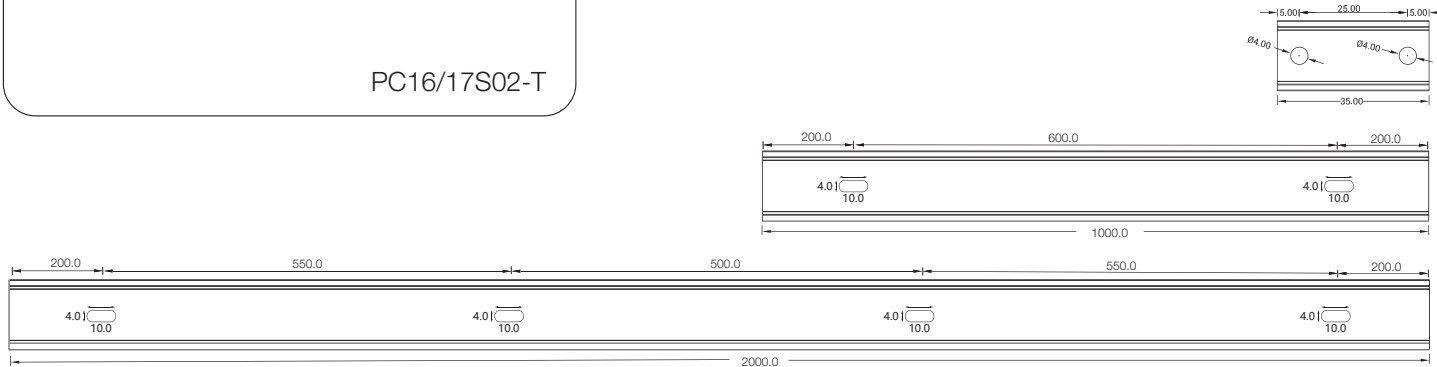
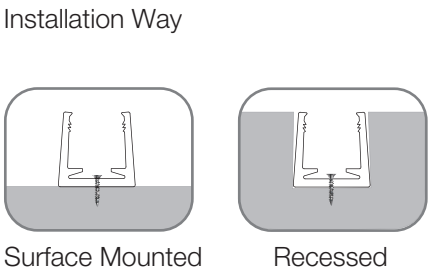
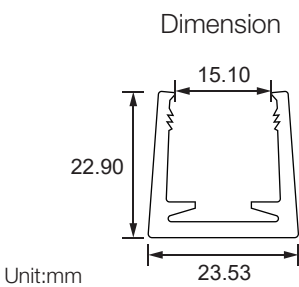
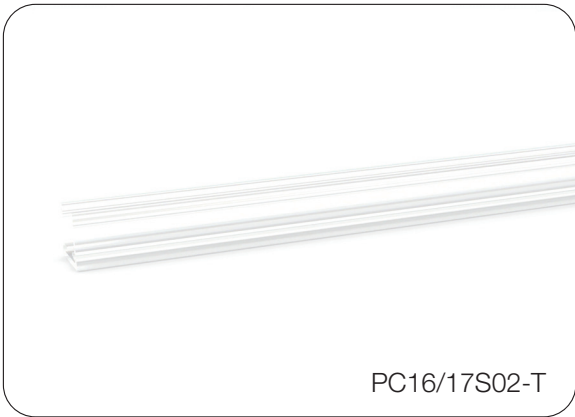

Model	W x H(mm)	Standard Length	Screw Holes	Holes Numbers	Suitable Product
PC16/17S02-T-100	23.53*22.90	1000mm	Φ4.0mm	2	F16, SF16



# LED Linear Flex Mounting Channel



SJJ-ZSH-008-PC

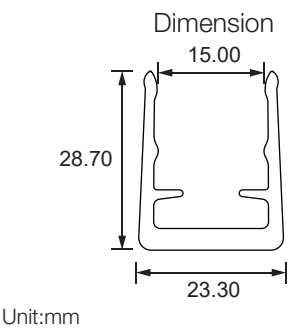

Installation Way

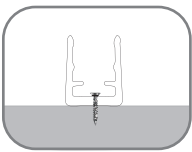

Surface Mounted

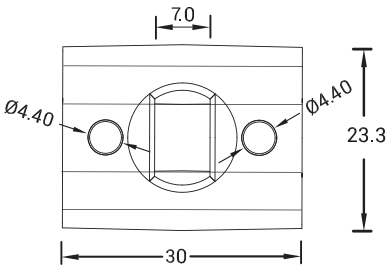

Model	W x H(mm)	Standard Length	Screw Holes	Holes Numbers	Suitable Product
SJJ-ZSH-008-PC	23.3*28.7	30mm	Ø4.40mm	2	F16, SF16

## 4. Stainless Steel Channel

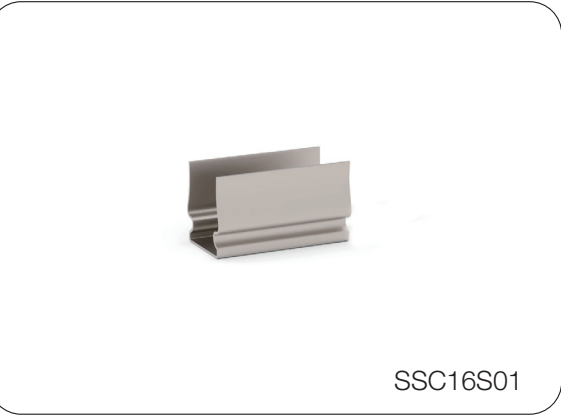

SSC16S01

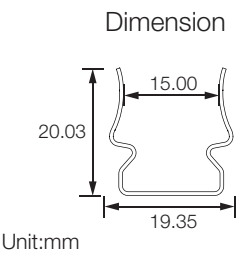

Installation Way

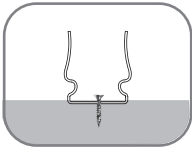

Surface Mounted

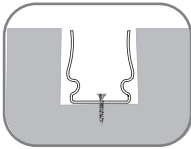

Recessed

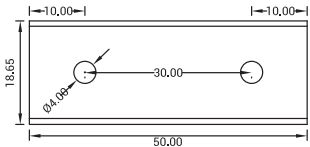

Model	W x H(mm)	Standard Length	Material	Screw Holes	Holes Numbers	Suitable Product
SSC16S01-05	19.35*20.03	50mm	Stainless Steel 316L	Ø4.0mm	2	F16, SF16

# LED Linear Flex Mounting Channel

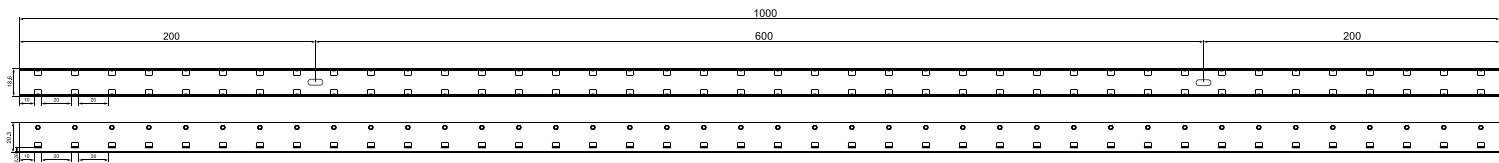
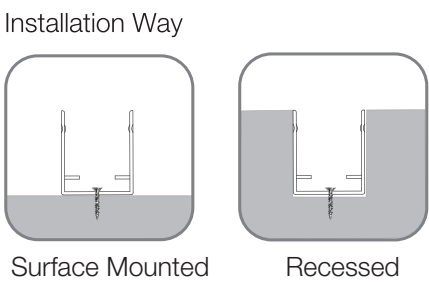
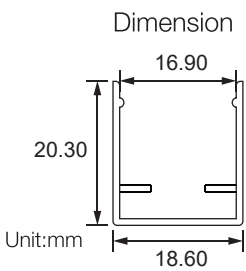
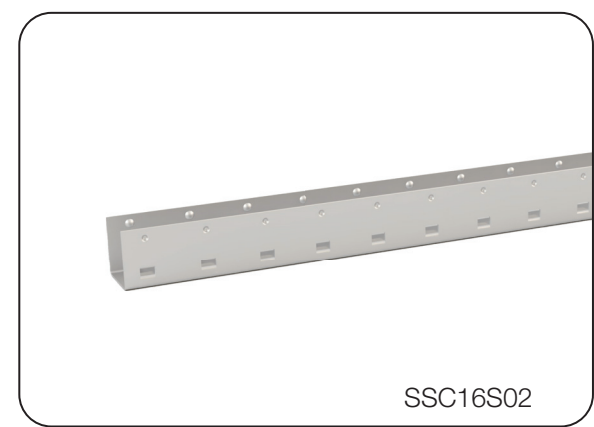

Model	W x H(mm)	Standard Length	Material	Screw Holes	Holes Numbers	Suitable Product
SSC16S02-100	18.60*20.3	1000mm	Stainless Steel 316L	4.0x10mm	2	F16, SF16

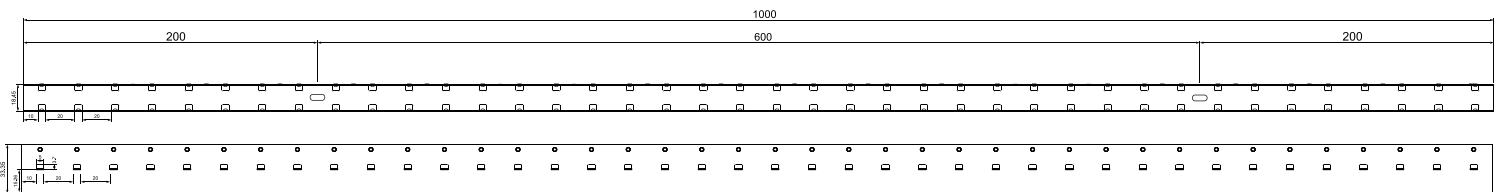
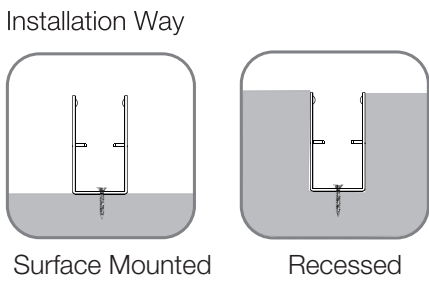
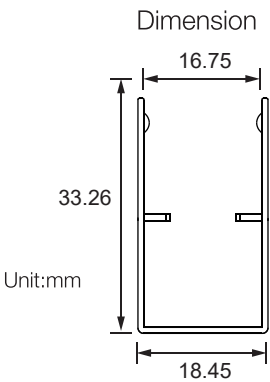
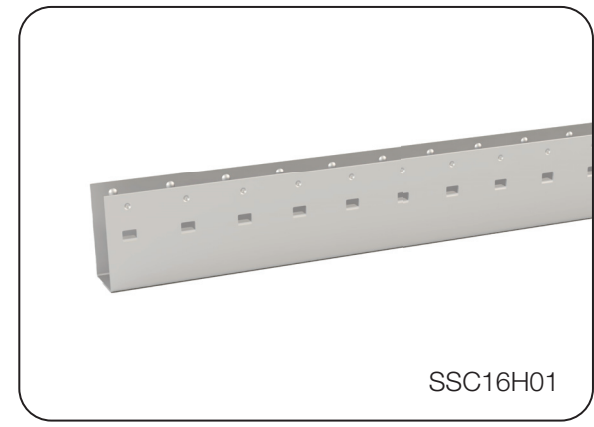

Model	W x H(mm)	Standard Length	Material	Screw Holes	Holes Numbers	Suitable Product
SSC16H01-100	18.45*33.26	1000mm	Stainless Steel 316L	4.0x10mm	2	F16, SF16

# LED Linear Flex Mounting Channel

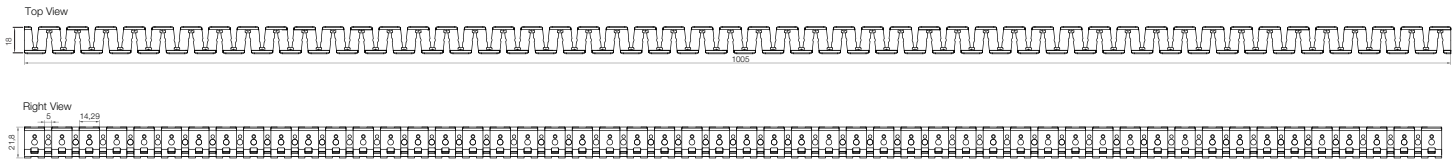
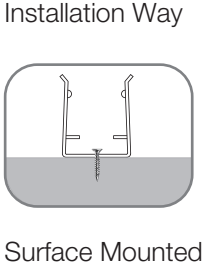
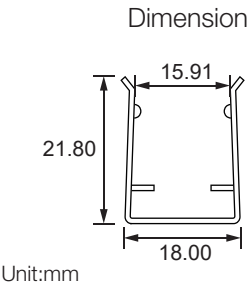
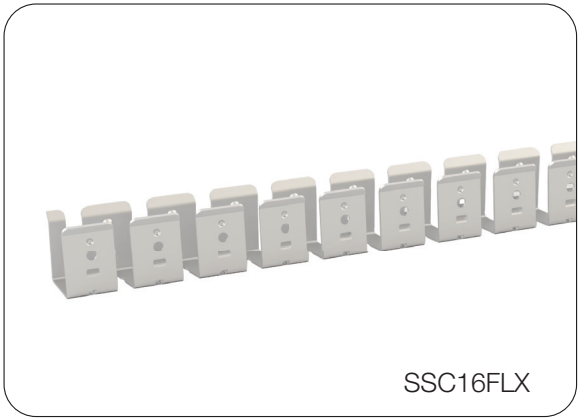

Model	W x H(mm)	Standard Length	Material	Suitable Product
SSC16FLX01	18.00*21.80	100mm	Stainless Steel 316L	F16, SF16
SSC16FLX03		300mm	Stainless Steel 316L	F16, SF16
SSC16FLX05		500mm	Stainless Steel 316L	F16, SF16
SSC16FLX10		1000mm	Stainless Steel 316L	F16, SF16

# LED Linear Flex Mounting Channel

## 5. Buried And Recessed Type



ALC-WL-B-02-A/B

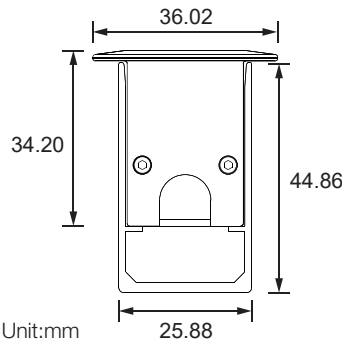

Installation Way

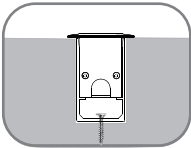

ALC-WL-B-02-A  
ALC-WL-B-02-B  
Buried Mounted

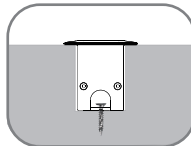

ALC-WL-B-02-A  
Recessed

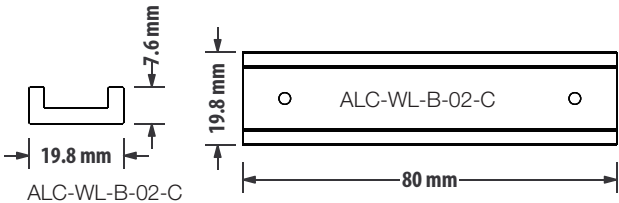
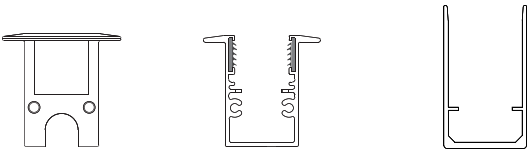

ALC-WL-B-02-C

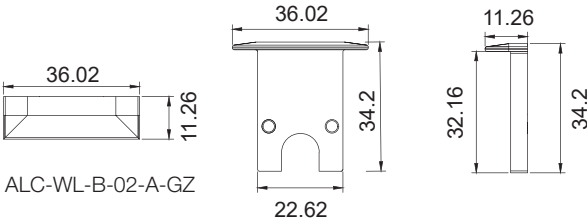

ALC-WL-B-02-A-GZ

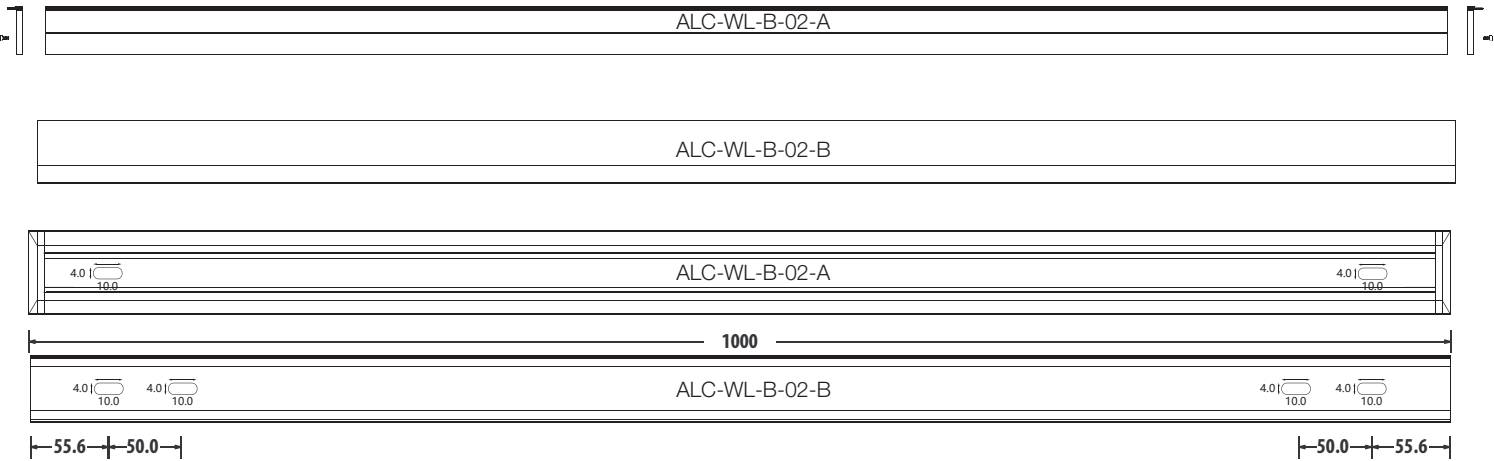
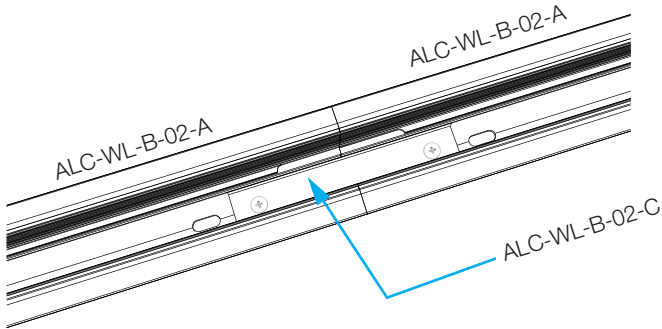

Model	W x H(mm)	Installation Way	Optional Length	Suitable Product
ALC-WL-B-02-A	36.02*34.20	Recessed	500mm/1000mm/2000mm	F16, SF16
ALC-WL-B-02-B	25.88*44.86	Buried Mounted	500mm/1000mm/2000mm	F16, SF16
ALC-WL-B-02-C	19.8*7.6	Connective Accessories	80mm	F16, SF16

# LED Linear Flex Mounting Channel

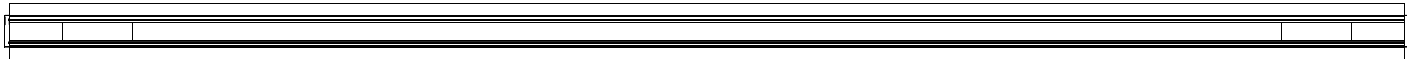
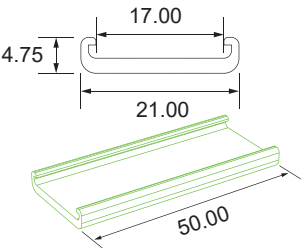
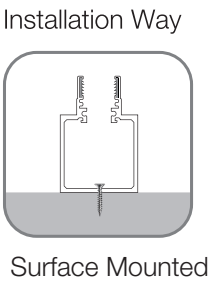
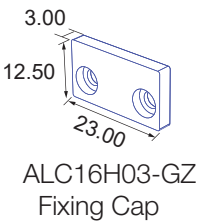
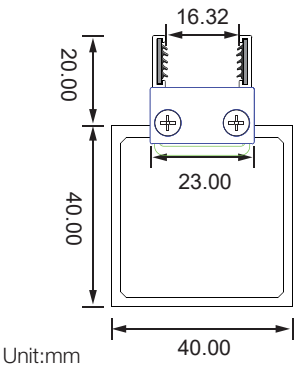
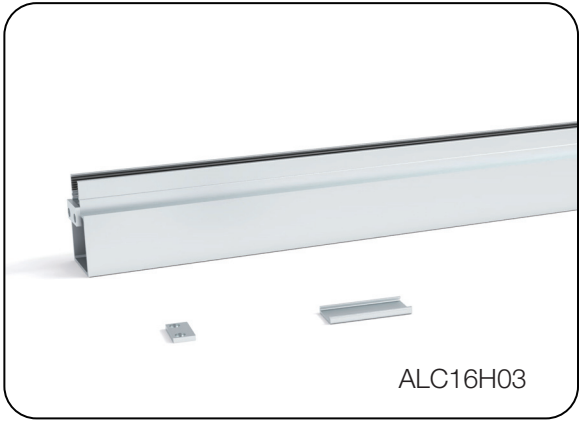

Model	W x H(mm)	Installation Way	Optional Length	Suitable Product
ALC16H03-100	40.00*60.00	Surface Mounted	1000mm/2000mm	F16, SF16
ALC16H03-200		Surface Mounted	1000mm/2000mm	F16, SF16

# Artflex LED Linear Flex Mounting Channel

## Glare-Free Kit

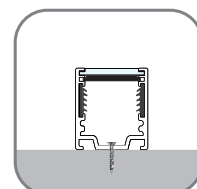
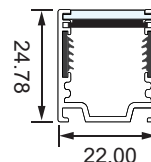
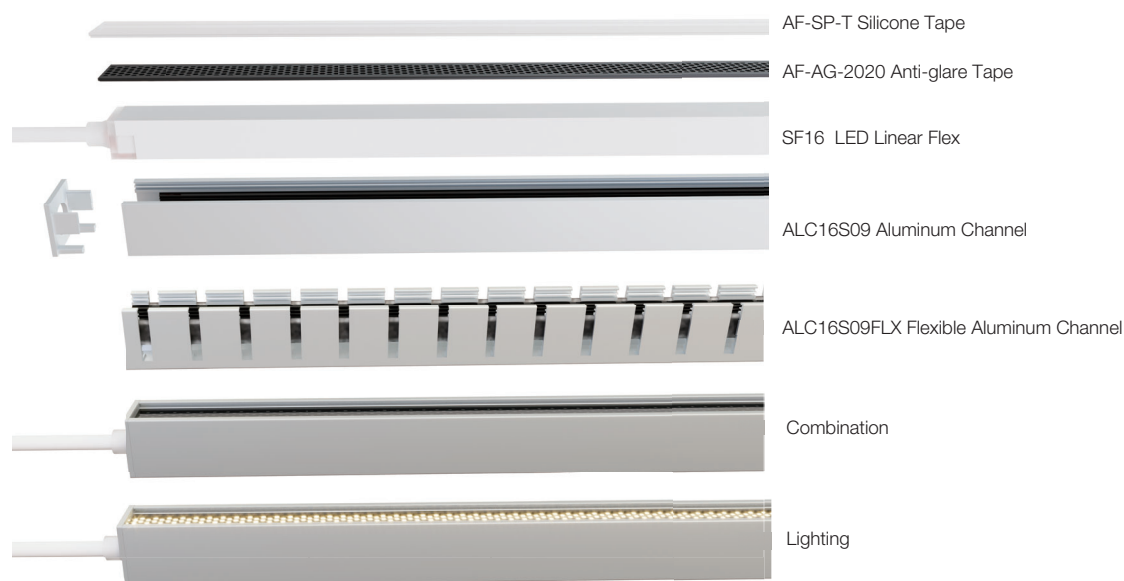

Surface Mounted

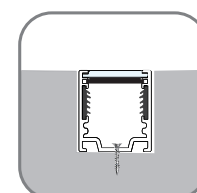

Recessed

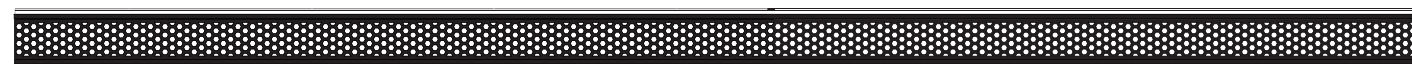

Model	W x H(mm)	Standard Length	Screw Holes	Holes Numbers	Suitable Product
AF-SP-AG & ALC16S09	22.00*24.78	1000mm	4.0x10mm	2	SF16

## Artflex Kit

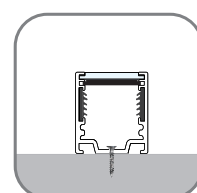
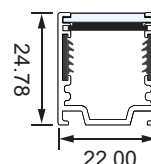
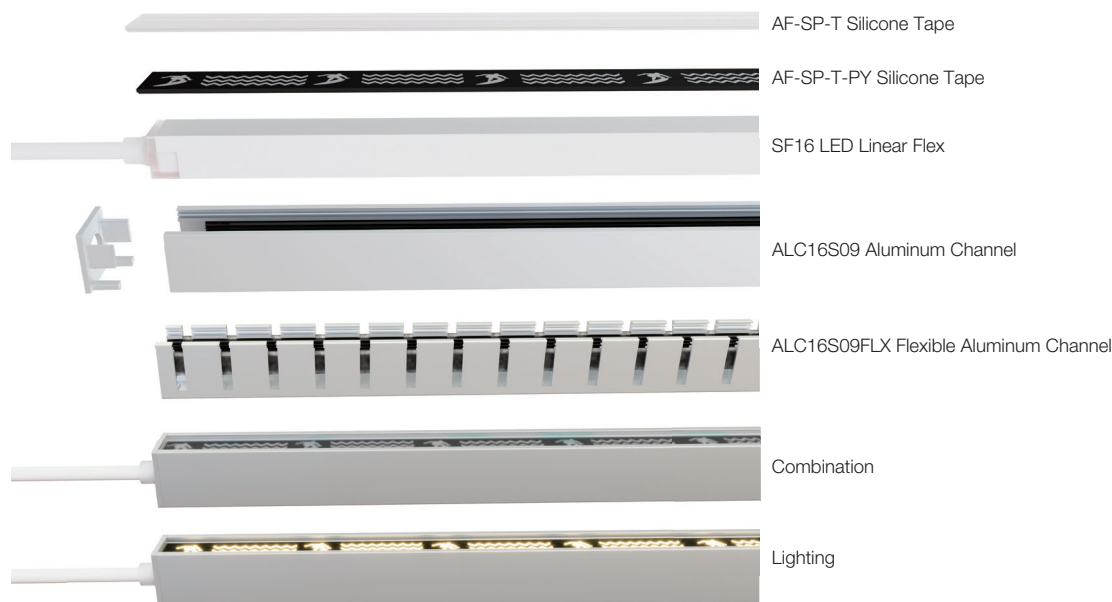

Surface Mounted

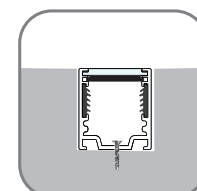

Recessed



Model	W x H(mm)	Standard Length	Screw Holes	Holes Numbers	Suitable Product
AF-SP-CP & ALC16S09	22.00*24.78	1000mm	4.0x10mm	2	SF16

# Artflex LED Linear Flex Mounting Channel

## ColorShift Kit



AF-SP-CL Color Silicone Tape  
(Red, Green, Blue optional)

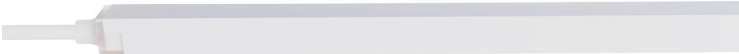

SF16 LED Linear Flex



ALC16S09 Aluminum Channel



ALC16S09FLX Flexible Aluminum Channel



Combination

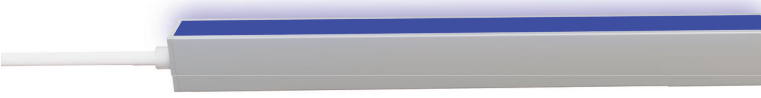

Lighting

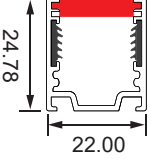

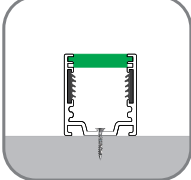

Surface Mounted

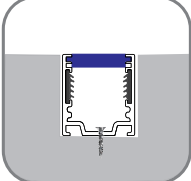

Recessed

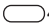

Model	W x H(mm)	Standard Length	Screw Holes	Holes Numbers	Suitable Product
AF-SP-CL & ALC16S09	22.00*24.78	1000mm	 4.0x10mm	2	SF16